

Short circuit relay type RMC-111D

uni-line

4189340119F (UK)

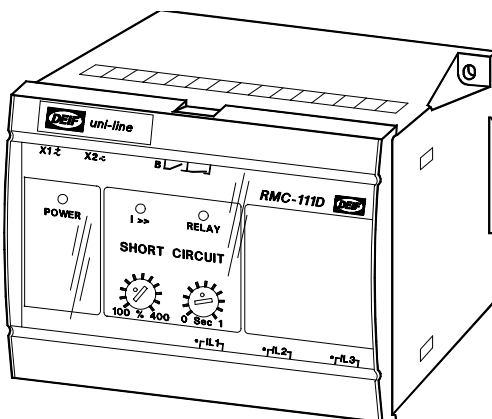

- Short circuit protection: $I >>$
- 3 phase measurement
- LED indication of fault condition
- Timer controlled tripping
- LED indication for activated relay
- 35 mm DIN rail or base mounting



DEIF A/S
Frisenborgvej 33, DK-7800 Skive
Denmark

Tel.: (+45) 9614 9614
Fax: (+45) 9614 9615
E-mail: deif@deif.com



1. Description

This short circuit relay type RMC-111D forms part of a complete DEIF series (the *uni-line*) of relays for protection and control of generators.

2. Label

The relay is provided with a label with the following data:

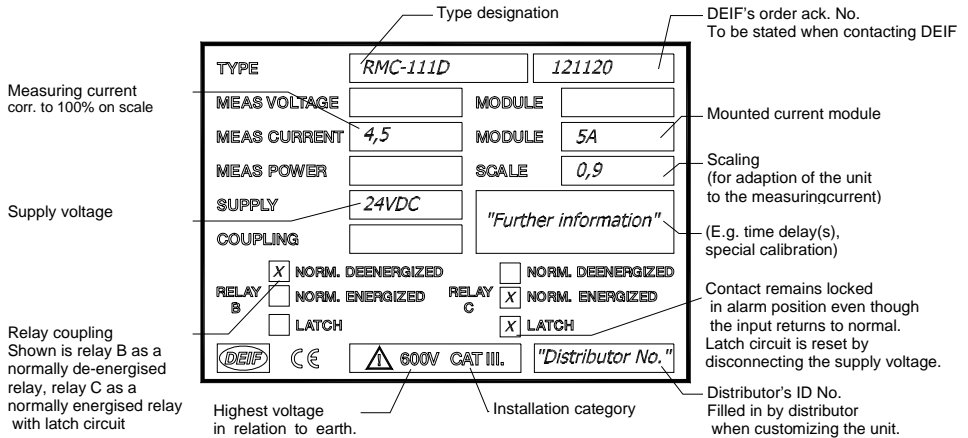

Note: The relay is provided with a 200 ms power-up relay, ensuring correct function of the relay on connection of the auxiliary voltage. Normally energised contacts ("NE") are not activated (contact does not open/close) until 200 ms after connection of the auxiliary voltage.

Likewise, the relay is provided with a 200 ms power-down circuit, ensuring supervision and maintenance of any set point exceeding for 200 ms after disconnection of the auxiliary voltage.

3. Mounting instructions

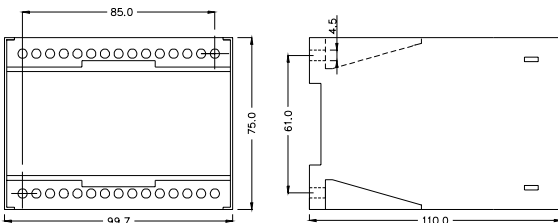

The RMC-111D is designed for panel mounting, being mounted on a 35 mm DIN rail, or by means of two 4 mm screws.

Weight: Approx. 0.650 kg

The design of the relay makes mounting of it close to other *uni-line* units possible, however make sure there are min. 50 mm between the top and bottom of this relay and other relays/units.

The DIN rail must always be placed horizontally when several relays are mounted on the same rail.

4. Connection diagram

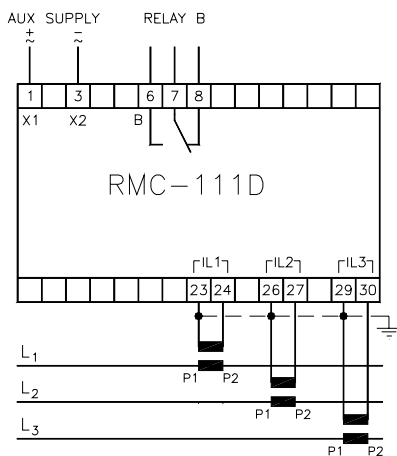

A 2A fuse may protect the auxiliary supply connection.

The relay is protected against ESD (electrostatic electricity), and further special protection against this during the mounting of the relay is not necessary.

When connected to 1 or 2 phases, unused inputs of the relay must be left open.

5. Start up instructions

5.1 Setting and indication

Setting of	LED/relay	
Short circuit current set point: (100...400%) of I_n	"I>>"	Yellow LED is lit when the set point has been exceeded, but the output contact has not yet been activated.
Time delay: 0...1 s/0...5 s/0...10 s	The contact is activated and the red LED is lit after the timer has expired.	

At the factory the time delays are set according to the order specifications.



If selective disconnection is required, a suitable time delay for the RMC-111D must be selected, taking the time delays of other relays into consideration.

If shortest possible time delay is selected (50 ms), unwanted disconnection may occur during synchronisation caused by a pulse signal which may be transmitted on closing of the generator circuit breaker.

To avoid this, connection of the auxiliary voltage to the relay via an auxiliary contact on the generator circuit breaker is recommended.

The built-in power-up circuit (200 ms) will then ensure that the relay is not activated until 200 ms after closing of the generator circuit breaker.

When setting the set points on the front of the RMC-111D an accuracy of $\pm 5\%$ of the scaling may normally be obtained.

If a higher accuracy is required, the unit (the generator) connected to the relay must be loaded using a load bank. On exceeding of the set point, the yellow LED of the RMC-111D is lit.

For RMC-111D relays connected to generators the following method is likewise applicable:

1. Reduce the excitation current of the generator to 0.
2. Short-circuit the generator
3. Slowly increase the excitation current, until the set point is exceeded

6. Technical specifications

Frequency range: 40...45...65...70Hz

Max. input current: 4 x I_n , continuously
20 x I_n , for 10 s (max. 75A)
80 x I_n , for 1 s (max. 300A)

Load: Max. 0.3VA per phase

Relay contact: 1 changeover switch

Contact rating: 250V-8A-2000A (AC), 24V-8A-200W (DC)

Response time: <50 ms

Galvanic separation: Between input, output and aux. supply: 3250V-50Hz-1 min.

Consumption: (Aux. supply) 3.5VA/2W